

Cali Bamboo Float Flooring Installation Guide

Hardest Floors in the World! Fossilized™ HD Janka Tested at over 5000+lbs:

Strips are cut from whole bamboo canes and are boiled to remove sugars and preserve the wood. Only premium quality strips are selected for manufacturing, while lower quality strips are sold to discount flooring companies. After 15 days of treatment and drying, a final moisture content of 6%-8% is achieved to ensure optimum stability. Whether you choose to nail, glue or float, Cali Bamboo's tongue and groove system makes every floor installation a breeze.



The following information provided by Cali Bamboo is intended to serve as a reference guide only. Please carefully read Cali Bamboo's installation, maintenance and warranty documentation prior to installation. Follow the National Wood Flooring Association's [Installation Guidelines](#) and recommendations when installing your floor.

Please note: Cali Bamboo offers free in house technical support as a courtesy to our customers. Consult with one of our bamboo flooring experts before; during or after you start your project. Contact help@calibamboo.com or (888.788.2254) to find answers to your specific installation questions that may be unique to your application.

Prior to Installation of Bamboo Floor:

Cali Bamboo Flooring is manufactured in accordance with accepted industry standards, which permit manufacturing, grading and natural deficiencies not to exceed 5%. Cali Bamboo Flooring will replace or refund the purchase price of any material deemed to be defective in excess of 5%.

- Installer/Owner assumes all responsibility to inspect all flooring before installation. If the installer/owner feels flooring material is off-grade, wrong color, improperly manufactured, wrong sheen level and finish problems, **DO NOT INSTALL** the flooring. Immediately contact the distributor/retailer from which the flooring was purchased. **NO CLAIM** will be accepted if flooring has been installed. **"Installation warrants acceptance"**. The installer/owner should select boards appropriately and relocate marginal boards to inconspicuous areas or cut out pieces with defects, if, and when required.
- Bamboo is a natural product, visible color variations may occur. We recommend opening all cartons of flooring before beginning installation to check for shade and then mixing cartons to achieve a natural variation throughout the entire floor.
- Prior to installation of the bamboo floor installer/owner must determine that the jobsite environment conditions and subfloor meets or exceeds all applicable National Wood Flooring Association's Installation Guidelines.
- After receiving your order, Cali Bamboo recommends sticker stacking (completely removing the flooring from boxes and cross stacking them with room for air to pass through) the flooring at the installation site, for a minimal of 72 hours before installation, to allow flooring to adjust to room temperature and humidity.

- Cali Bamboo Flooring declines any responsibility for flooring failure resulting from substrate and/or jobsite environmental deficiencies.
- Use appropriate floor leveling products for correcting subfloor deficiencies.
- The use of the stain and finish touch-up kit and putty during installation should be accepted as normal procedure.
- Since bamboo expands with any increase in moisture content, we recommend leaving at least 1/2" expansion space between flooring and all walls and vertical objects such as walls, cabinets, pipes, etc.
- Moisture difference between the bamboo floor and the sub-floor should not be more than 3%.
- Cali Bamboo recommends using a moisture control system on all subfloor types.
- Determine the best installation method that suits your application. Cali Bamboo floors may be Floated (not secured to the subfloor), Glued, or Nailed. Follow the instructions designated for the best installation method suitable for your project.
- Upon ordering of wood floor material consider adding additional 8% to allow for cutting waste (5%) and grading allowance (3%).
- The selection of mechanical fasteners and floor nailers vary by manufacturer and offer the choice of manual or air-assisted. It is the installer's responsibility to ensure that the fastener is properly seated as dimpling of the bamboo face or edge is not considered a manufacturing defect.
- Occasional noise in mechanically fastened floors is due to abnormal structural movement and in many cases is related to changes in environmental conditions. Cali Bamboo Flooring does NOT warrant against mechanical fastened related noise issues.

Concrete Testing:

- **Tramex Concrete Moisture Encounter:** Moisture readings should not exceed 4.5% on the upper scale. The system must be turned down to 65°F and maintained 24 hours prior to installation.
- **Calcium Chloride Test (ASTM F 1869):** The maximum vapor emissions cannot exceed 3lbs/1000SF in 24 hours.
- **In-Situ Probe Method (ASTM F 2170):** The Rh levels should not exceed 75%.

If excessive moisture levels are present or anticipated, use appropriate moisture retardant system per recommendation of adhesive manufacture.

NOTE: TEST RESULTS ARE ONLY APPLICABLE THE DAY OF TESTING; THIS TESTING DOES NOT ENSURE THAT MOISTURE WILL NOT FLUCTUATE WITH SEASONAL CHANGES. SUBFLOOR MAY REQUIRE A MOISTURE RETARDANT SYSTEM. FOLLOW ADHESIVE MANUFACTURES GUIDELINES. CALI BAMBOO FLOORING DOES NOT WARRANT AGAINST MOISTURE AND/OR ADHESIVE RELATED PROBLEMS.

Floating Installation Method:

The Floating method (not securing to the subfloor) offers a fast, convenient, and cost efficient way to install a Bamboo Floor. The floating method is also known to produce a very stable floor due to the fact that it is not secured to the subfloor. Cali Bamboo's Wide Plank flooring is 30-60% wider and has been designed with the floating install method in mind, however, all of Cali Bamboo's floors may be installed using the floating method. Floating floors are also ideal for applications that have multiple floor coverings that may be too troublesome to remove. Floating bamboo floors need proper expansion areas as do other types of bamboo installations. Small layouts or square rooms may only need 1/2" expansion. If the installation flows into other rooms and continuous runs in excess of 30 feet, a greater expansion is required, approximately 1/16" for every ten (10) feet. NEVER install any floating floors against any vertical fixed object such as fireplace, columns, floor outlets, etc. Failure to follow this guideline may result in tenting or buckled floors.



Recommended Tools:

- | | |
|---|-----------------------------|
| Titebond® Tongue & Groove Flooring Glue | Undercut or jamb saw |
| Underlayment (AquaBar, Silicone Vapor Shield or asphalt saturated felt paper) | Hammer |
| Wood or plastic spacers (1/2") | Tape measure |
| Flat bar or pull bar | Pencil |
| Tapping block (trimmed piece of flooring) | Chalk line |
| Miter saw (chop-saw) | Earplugs and safety glasses |

Radiant Heat Systems:

Cali Bamboo flooring is recommended for use over radiant heat systems only if Bamboo flooring surface temperature does not exceed 80 degrees Fahrenheit. If possible, check with the heating manufacture to successfully limit the maximum temperature in order not to exceed recommended bamboo surface temperature. Relative Humidity must be maintained between 40-60%. Sub floor moisture should never vary greater or less than 3% than that of the flooring moisture content. 5/8" Plywood or 3/4" oriented strand (OSB) boards are recommended for subfloor materials in radiant installations. The floating installation method is the most suitable for use with radiant heat systems. It is the responsibility of the installer to ensure that the recommended environmental conditions are met and are suitable for installation of Cali Bamboo flooring products.

- Radiant heat system must be turned on and in operation for at least 6 days before installation.
- The system must be turned down to 65°F and maintained 24 hours prior to installation.
- Once the installation is complete the system must be turned back on and brought back up to normal operating temperature slowly (over a period 4-5 days).

Installation Steps:

1. It is recommended to install the planks parallel to the longest wall.
2. Using spacers to maintain the expansion space, begin by laying the first plank in a corner with the long grooved side toward the long wall.
3. Apply a small continuous consistent bead of Titebond T&G flooring glue along the bottom side of the flooring groove.
4. Connect the short side of the second plank together with the mating side of the first plank.
5. Cut the last plank and complete the row. Use the remaining plank to start the second row.
6. Make sure to offset the end joints of consecutive rows by a minimum of 6 inches for best appearance.
7. Continue the second row by connecting the short edges of the planks first and use a pull bar to tap the long edges together.
8. The last row may require rip cutting the planks to size, be sure to cut enough to maintain proper expansion space.
9. As with the other rows, complete the last row by connecting the short edges first and using a pull bar to tap the long edges together.

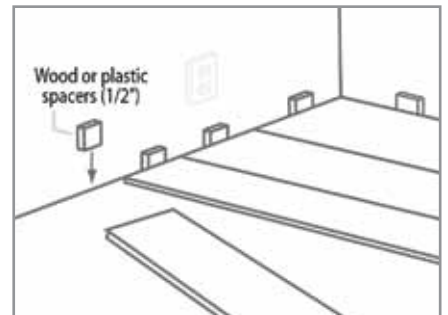
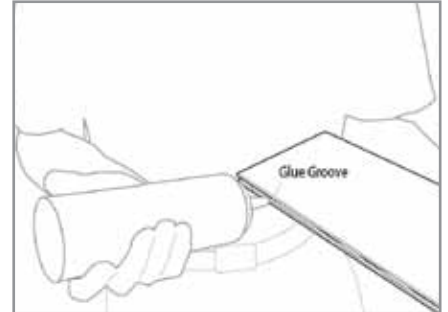

Clean Up:

Use Bostik's Adhesive remover towels to immediately remove any adhesive on flooring surface as you go.

After Installation:

Allow the newly installed floor to fully cure based on adhesive recommendations before walking or moving furniture onto the floor.

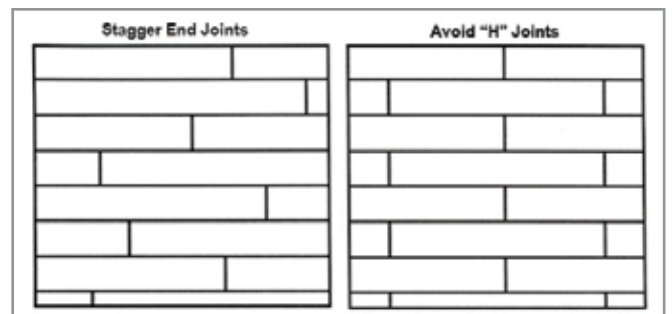

Maintenance:

Cali Bamboo flooring is treated with an industry-leading scratch resistant coating, and its density and strength surpasses almost any other flooring in the world. Bamboo flooring is tough, but all hardwood flooring is pervious to dents, scratches, discoloration or other natural or man-made damage. Prevention is a big part of the care for bamboo floors. Cali bamboo recommends to Vacuum or sweep the floor on a regular basis or as needed to remove dirt, sand or grit. Soak up spills immediately using a dry towel or dry mop. Never wet-mop a hardwood floor. Protect floor from moving furniture by using "feet" or protective caps. Pick up heavy objects; do not slide furniture or appliances across the floor. Keep pets nails trimmed to avoid excess scratching. Avoid rubber backing, vinyl or non-ventilated rugs. Limit direct sunlight on floor by using curtains and blinds in areas that are exposed to high UV rays. Maintain humidity between 40% -60%. To remove hard-to-clean substances such as chewing gum, use Goof-Off or Goo-Gone. Floor wax and oil should not be used.

Top Coating:

In areas such as bathrooms, kitchens, and spaces where food service occurs, top-coating the floor will help prevent against moisture damage. In heavy food service areas such as restaurants, two to three top-coats are recommended. Cali Bamboo recommends using Bona flooring finish products www.bona.com in these areas. Carefully read and follow all BonaKemi finish application instructions.

Please contact help@calibamboo.com or speak to one of our experts at **(888.788.2254)** for more information.

